

BOTAMENT[®]

SYSTEMBAUSTOFFE 

JohnsonDiversey
Clean is just the beginning



BOTAMENT[®] MF 300

Mosaic joint 2 K

Bathrooms, showers and sanitary areas (foam cleaning)

Suma
D10.1
J-Spray

TASKI
Sani Cid
J-Flex*



1. Connect the J-Flex Dosing Bottle to the water hose.

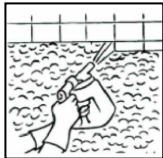

2. **First pre-wet the surface to be cleaned with plenty of water.**

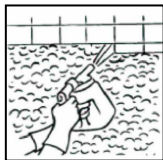

3. Then lather up all water-proof areas **from bottom to top** with the product solution from the J-Flex dosing bottle. Attack heavy soiling using the Jonmaster Scrub Mop. Leave the foam to take effect for 3 to 5 minutes.

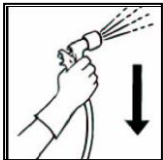

4. Rinse the lathered area **from bottom to top** with plenty of clear water.

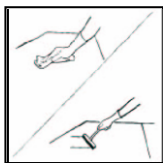

5. Remove the water from the floor using the squeegee. Dry fixtures with the yellow cloth to avoid water stains.

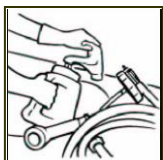

6. When finished clean cleaning cloth and mops and clean the equipment used.

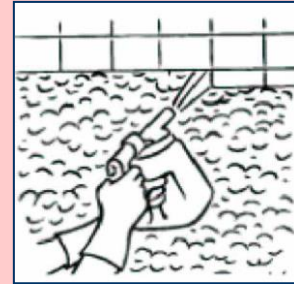

Dosing

- Via J-Flex-System

Tools

- J-Flex dosing bottle
- Water hose
- Squeegee
- Red cloth (for toilet cleaning)
- Yellow cloth (for other sanitary areas)
- Jonmaster Scrub Mop

Check Points

- Inspect cleanliness of joints
- Cleaned surface free of dirt and lime
- No cracks in the tiles
- No lime scale residue on fixtures

PLEASE NOTE:

Prior to using the cleaning agents the surface to be cleaned must be wetted with water; after cleaning it must be rinsed with plenty of water. The ZDB datasheet "CLEANING, PROTECTING, MAINTAINING" (version June 2007) must be followed.

SAFETY TIPS

Attention: Slippery Surface! Please follow the safety tips on the safety data sheet and on the instruction manual!

